

1/1000 ÖLÇEKLİ BEŞEVLER REVİZYONU UYGULAMA İMAR PLANI

GÖSTERİM

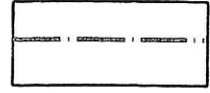

PLAN DEĞİŞİKLİĞİ SINIRI

K

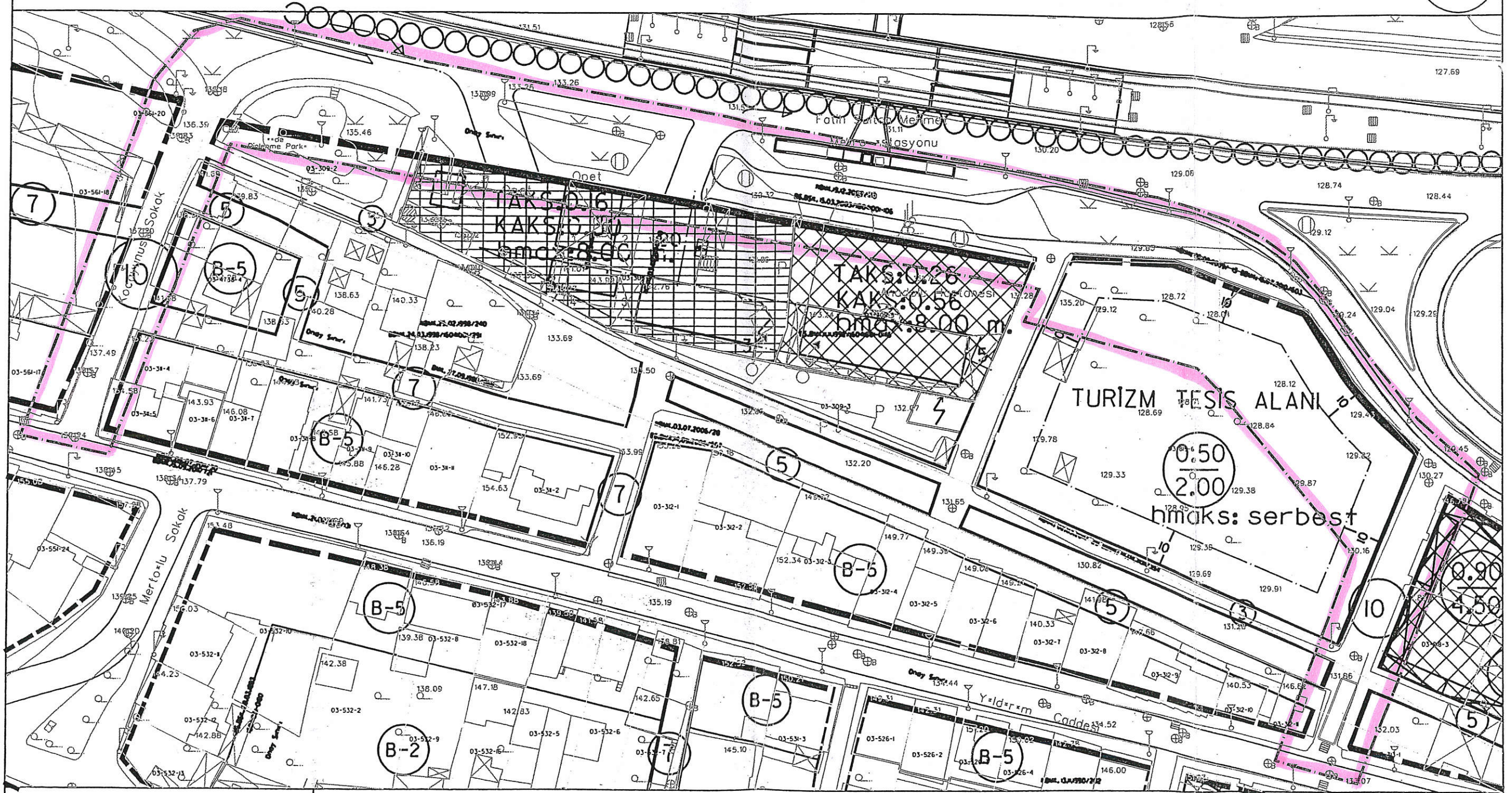
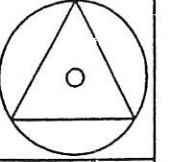

PAFTA NO	H21c05c4a
KADASTRAL NO	819 ADA 6 PARSEL
B.Ş.B.M.K. KARAR TARİHİ	16.10.2014/1074 AŞKİ: 31.10.2014 - 01.12.2014



İLÜFER BELEDİYESİ 1/5000 ÖLÇEKLI NAZIM İMAR PLANI DEĞİŞİKLİĞİ

TALİ İŞ MERKEZİ ALANI



BURSA-H22-D-01-D

414 882.50

A 455 068.66